

# BTP2/..

- load transfer through flat steel dowels
- with adhering flange
- with coating-flange



### FEATURES

high edge protection due to steel edges t=10 mm

### APPLICATIONS

parking decks, parking garages, underground garages, ramp crossings, pedestrian bridges, all industrial applications, shopping centres, railway stations, airports, residential, office and administration buildings

### MATERIAL

hot-dip galvanised steel, stainless steel V2A (V4A on request)

### COVERING TYPES

asphalt, coating, screed, natural and stone slabs, bitumen welding membrane, liquid plastic

### TRAFFICABILITY

passenger cars, trucks, fork-lifts

### FORMED PARTS

corner piece, end plate

### NOTES

Support leg perforated and lowered.

Adhesive flange joints must be fully welded and ground flat on the sealing side.

### TECHNICAL DATA

Material/sheet thickness: 4 mm  
Supply length: 3 mtr

### DESIGNS

ARTICLE NO.	HEIGHT (h)	RECESS (BxT)
BTP2/45	45 mm	150 x 20 mm
BTP2/50	50 mm	150 x 20 mm
BTP2/60	60 mm	150 x 20 mm
BTP2/70	70 mm	150 x 20 mm
BTP2/80	80 mm	150 x 20 mm

Special heights on request.

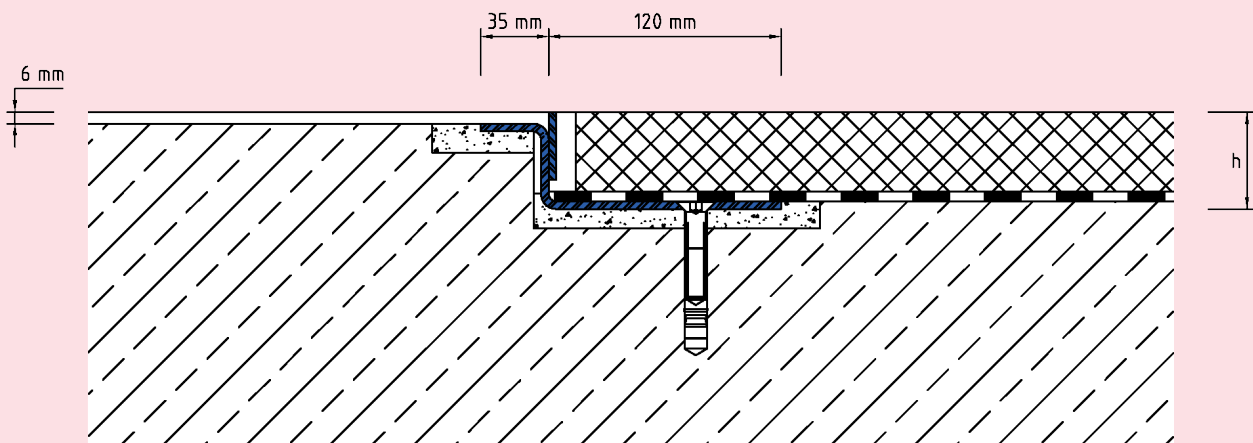

BTP2

Subject to technical change without notice.